



CUSTOM CONTROL PANEL OPERATORS INTRODUCTION



Class I, Div. 1 & 2, Groups B, C, D
 Class I, Zones 1 & 2, Groups IIB, IIA
 Class II, Div. 1 & 2, Groups E, F, G
 Class III
 NEMA 3, 4, 4X, 7 (B, C, D) 9 (E, F, G)

See Area Classification Chart below

FEATURES-SPECIFICATIONS

Applications

G Series custom control panel operators are designed for use in hazardous locations when installed in suitable enclosures such as B7E EXB, XJB, DB, SWB and GCS Series boxes and B7, Y7 Starter Enclosures.

Features

- Operators are all aluminum except for certain movable parts which are stainless steel, all other parts such as screws are either stainless steel or plated steel
- Threaded bodies are all 3/4"-14 NPSM thread
- Control stations can be grouped into a single assembly thus reducing installation time and cost
- Junction boxes may be used to mount operators along with glass lens for viewing internally mounted meters. Additional relays, timers, terminal blocks, or other equipment may also be internally mounted to provide a single centralized control unit.
- Custom operators other than standard assemblies listed may be ordered by proper catalog number from custom operator ordering system pages C72 & C73

Electrical Rating

Push button stations, selector switches Heavy duty 600 VAC max.

Pilot lights 120 VAC.

Dimensions

See Dimensional information for G Series operators on page C74.

Recommended Operator Selection

Short Style

DB/SWB/GCS Enclosures. Assemblies with wall thickness up to 1/2" thick.

Long Style

All B7E/XJB Enclosures. EXB (see page E35) enclosures with cover thickness up to 1-1/2" thick.

Extended Style

EXB larger size enclosures (see page E35) with cover thickness up to 2-1/2" thick.

Killark long and extended push buttons, selector switches, reset and potentiometer operators are CENELEC/ATEX EExd IIB+H2 when installed in series EXB*CEN and GR*CEN enclosures.

For pilot lights and illuminated push buttons in CENELEC/ATEX applications see page C65.

CONTACT BLOCK RATINGS – A600/P600						
CURRENT	120 VAC	240 VAC	480 VAC	600 VAC	125 VDC	250 VDC
INRUSH	60	30	15	12	.55	.27
BREAKING	6	3	1.5	1.2	.55	.27
CARRYING	10	10	10	10	2.55	2.55

Note: Contact blocks can be stacked four deep maximum.

AREA CLASSIFICATION CHART FOR OPERATORS					
G01 ^④	G017 ^②	G030 ^②	G057 ^②	GOL2 ^④	GOL38 ^③
G02 ^④	G018 ^②	G034 ^②	G058 ^②	GOL3 ^④	GOL39 ^③
G05 ^④	G019 ^②	G035 ^② G036 ^③	G059 ^②	GOL4 ^④	GOL113 ^③
G06 ^④	G021 ^②	G037 ^③	G0113 ^③	GOL5 ^④	GOL114 ^③
G07 ^④	G022 ^②	G038 ^③	G0114 ^③	GOL6 ^④	GOLRST ^④
G08 ^③	G023 ^②	G039 ^③	G0133 ^②	GOL7 ^④ GOL8 ^③	GOM1 ^⑤
G010 ^④	G025 ^②	G040 ^①	G0134 ^②	GOL14 ^④	GOR11 ^④
G014 ^④	G026 ^②	G050 ^②	G0B3 ^④	GOL15 ^④	GORST ^④
G015 ^④	G027 ^②	G051 ^②	G0B4 ^④	GOL36 ^③	G011388 ^②
G016 ^②	G028 ^②	G056 ^②	GOL1 ^④	GOL37 ^④	G011372 ^②

① Class II Div. 1 & 2 Group EFG NEMA 9EFG

② Class I Div. 1 & 2 Group CD, Class II Div. 1 & 2 Group EFG, Class III NEMA 7CD, 9EFG

③ Class I Div. 1 & 2 Group BCD, Class II Div. 1 & 2 Group EFG, Class III NEMA 3, 4, 7BCD, 9EFG

④ Class I Div. 1 & 2 Group BCD, Class II Div. 1 & 2 Group EFG, Class III NEMA 3, 4, 4X, 7BCD, 9EFG

⑤ Class I Div. 1 & 2 Group CD, Class II Div. 1 & 2 Group EFG, Class III NEMA 3, 4, 7CD, 9EFG



SELECTOR SWITCHES



Selector Switch

Class I, Div. 1 & 2, Groups B, C, D^④
 Class I, Zones 1 & 2, Groups IIB, IIA
 Class II, Div. 1 & 2, Groups E, F, G
 Class III
 NEMA 3, 4, 4X, 7 (B, C, D) 9 (E, F, G)

See Area Classification Chart
 page C62 for Details

LISTED - File E12379

Certified - File LR11714
 See files for details or call Killark.

FEATURES-SPECIFICATIONS

G SELECTOR SWITCH MAINTAINED CONTACT												
CATALOG NUMBER ^①			CONTACT ARRANGEMENT ^③	TYPE OF OPERATION ^②								
SHORT ^④	LONG	EXTENDED										
G025-2A3F	G05-2A3F N34	G0L52A3	<table style="display: inline-table; border: none;"> <tr> <td style="text-align: center;">LEFT</td> <td style="text-align: center;">RIGHT</td> </tr> <tr> <td style="text-align: center;"> </td> <td style="text-align: center;"> </td> </tr> </table>	LEFT	RIGHT			TWO POSITION				
LEFT	RIGHT											
G025-3C3G	G05-3C3G N34	G0L53C3	<table style="display: inline-table; border: none;"> <tr> <td style="text-align: center;">LEFT</td> <td style="text-align: center;">CENTER</td> <td style="text-align: center;">RIGHT</td> </tr> <tr> <td style="text-align: center;"> </td> <td style="text-align: center;"> </td> <td style="text-align: center;"> </td> </tr> </table>	LEFT	CENTER	RIGHT				THREE POSITION		
LEFT	CENTER	RIGHT										
G025-4H8H	G05-4H8H N34	G0L54H8	<table style="display: inline-table; border: none;"> <tr> <td style="text-align: center;">1</td> <td style="text-align: center;">2</td> <td style="text-align: center;">3</td> <td style="text-align: center;">4</td> </tr> <tr> <td style="text-align: center;"> </td> <td style="text-align: center;"> </td> <td style="text-align: center;"> </td> <td style="text-align: center;"> </td> </tr> </table>	1	2	3	4					FOUR POSITION
1	2	3	4									

G SELECTOR SWITCH MAINTAINED CONTACT WITHOUT CONTACTS				
G025-2A0F	G05-2A0F N34	G0L52A	NONE	TWO POSITION
G025-3C0G	G05-3C0G N34	G0L53C	NONE	THREE POSITION
G025-4H0H	G05-4H0H N34	G0L54H	NONE	FOUR POSITION

G SELECTOR SWITCH SPRING RETURN										
G026-3F	G06-3F N34	G0L63	<table style="display: inline-table; border: none;"> <tr> <td style="text-align: center;">LEFT</td> <td style="text-align: center;">RIGHT</td> </tr> <tr> <td style="text-align: center;"> </td> <td style="text-align: center;"> </td> </tr> </table>	LEFT	RIGHT			TWO POSITION SPRING RETURN TO LEFT 1 N.O./1 N.C		
LEFT	RIGHT									
G027-6G	G07-6G N34	G0L76	<table style="display: inline-table; border: none;"> <tr> <td style="text-align: center;">LEFT</td> <td style="text-align: center;">CENTER</td> <td style="text-align: center;">RIGHT</td> </tr> <tr> <td style="text-align: center;"> </td> <td style="text-align: center;"> </td> <td style="text-align: center;"> </td> </tr> </table>	LEFT	CENTER	RIGHT				THREE POSITION SPRING RETURN TO CENTER FROM RIGHT OR LEFT 2 N.O.
LEFT	CENTER	RIGHT								
G034-6G	G014-6G N34	G0L146	<table style="display: inline-table; border: none;"> <tr> <td style="text-align: center;">LEFT</td> <td style="text-align: center;">CENTER</td> <td style="text-align: center;">RIGHT</td> </tr> <tr> <td style="text-align: center;"> </td> <td style="text-align: center;"> </td> <td style="text-align: center;"> </td> </tr> </table>	LEFT	CENTER	RIGHT				THREE POSITION SPRING RETURN TO CENTER FROM RIGHT, MAINTAIN IN LEFT 2 N.O.
LEFT	CENTER	RIGHT								
G035-6G	G015-6G N34	G0L156	<table style="display: inline-table; border: none;"> <tr> <td style="text-align: center;">LEFT</td> <td style="text-align: center;">CENTER</td> <td style="text-align: center;">RIGHT</td> </tr> <tr> <td style="text-align: center;"> </td> <td style="text-align: center;"> </td> <td style="text-align: center;"> </td> </tr> </table>	LEFT	CENTER	RIGHT				THREE POSITION SPRING RETURN TO CENTER FROM LEFT, MAINTAIN IN RIGHT 2 N.O.
LEFT	CENTER	RIGHT								

G SELECTOR SWITCH SPRING RETURN WITHOUT CONTACTS				
G026-0F	G06-0F N34	G0L6	NONE	TWO POSITION SPRING RETURN TO LEFT
G027-0G	G07-0G N34	G0L7	NONE	THREE POSITION SPRING RETURN TO CENTER FROM RIGHT OR LEFT
G034-0G	G014-0G N34	G0L14	NONE	THREE POSITION SPRING RETURN TO CENTER FROM RIGHT, MAINTAIN IN LEFT
G035-0G	G015-0G N34	G0L15	NONE	THREE POSITION SPRING RETURN TO CENTER FROM LEFT, MAINTAIN IN RIGHT

^① Refer to catalog page C62 to select proper operator for enclosure, C70 & C71 for Accessories, C62 for complete details on Area Classification of operators, C74 for Dimensional Information, C72 for Special Contact Configurations.

^② Nameplates are Double sided. 2 position marked OFF-ON and Blank on other side. 3 position marked HAND-OFF-AUTO and Blank on other side. 4 position is Blank.

^③ Contact Blocks are shown in their normal position.

^④ Short style operators are suitable for Class I Group C & D, Class II Group E,F,G only.



DIMENSIONS

G DIMENSIONS					
SERIES	FIGURE	A	B	C	D
G01	1	15/16"(24)	1-3/4"(44)	3-7/16"(87)	1-1/4"(32)
G02	3	13/16"(21)	2"(51)	3-3/4"(95)	—
G0B3	4	1-1/8"(29)	2"(51)	2-3/4"(70)	1-9/16"(40)
G0B4	5	2-3/8"(60)	2-1/4"(57)	4"(101)	1-13/16"(46)
G05	9	1-5/16"(33)	1-3/4"(44)	3-7/16"(87)	1-1/4"(32)
G06,G07,G014,G015	9	1-5/16"(33)	1-3/4"(44)	3-13/16"(97)	1-1/4"(32)
G08	10	2-9/16"(65)	1-3/4"(44)	3-1/2"(89)	1-1/4"(32)
G010	11	1-5/16"(33)	1-3/4"(44)	4"(101)	1-1/4"(32)
G016,G018	7	1-1/4"(32)	1"(25)	13/16"(21)	1-1/2"(38)
G017,G019	7	13/16"(21)	1"(25)	13/16"(21)	1-1/2"(38)
G021	1	15/16"(24)	3/4"(19)	2-7/16"(62)	1-1/4"(32)
G022	3	13/16"(21)	1"(25)	2-3/4"(70)	—
G023	4	1-1/8"(29)	1"(25)	1-3/4"(44)	1-9/16"(40)
G025	9	1-5/16"(33)	3/4"(19)	2-7/16"(62)	1-1/4"(32)
G026,G027,G034,G035	9	1-5/16"(33)	3/4"(19)	2-13/16"(71)	1-1/4"(32)
G030	11	1-5/16"(33)	3/4"(19)	3"(76)	1-1/4"(32)
G036,G037,G038,G039	10	2-9/16"(65)	1-3/4"(44)	3-7/8"(98)	1-1/4"(32)
G040	2	15/16"(24)	11/16"(17)	1"(25)	1-1/4"(32)
G050	7	1-1/2"(38)	2"(51)	6-5/16"(160)	2-5/16"(59)
G051	7	2-1/4"(57)	1-5/8"(41)	5-9/16"(141)	1"(25)
G056,G057,G058,G059	10	2-9/16"(65)	3/4"(19)	2-7/8"(73)	1-1/4"(32)
G0113,G0114	6	1"(25)	2"(51)	3-5/8"(93)	1-13/16"(46)
G0133,G0134	6	1"(25)	1"(25)	2-5/8"(67)	1-13/16"(46)
GO-11388-078	8	1-5/16"(33)	3/4"(19)	N/A	1-1/2"(38)
GO-11372-093	8	1-5/16"(33)	3/4"(19)	N/A	1-1/2"(38)
GOR11	3	13/16"(21)	2"(51)	4-1/8"(105)	—
GO-RST	2	15/16"(24)	2-5/16"(59)	2-3/8"+6"(60)	1-1/4"(32)
GOM1	1	1-7/8"(48)	1-7/16"(37)	4"(101)	1-5/8"(41)
EXTENDED LENGTH OPERATORS:					
GOL1	1	15/16"(24)	2-3/4"(70)	4-7/16"(113)	1-1/4"(32)
GOL2	3	13/16"(210)	2-3/4"(70)	4-1/2"(114)	—
GOL3	4	1-1/8"(29)	2-3/4"(70)	3-3/8"(86)	1-9/16"(40)
GOL4	5	2-3/8"(60)	2-3/4"(70)	4-5/8"(117)	1-13/16"(46)
GOL5	9	1-5/16"(33)	2-3/4"(70)	4-7/16"(113)	1-1/4"(32)
GOL6,GOL7,GOL14,GOL15	9	1-5/16"(33)	2-3/4"(70)	4-13/16"(122)	1-1/4"(32)
GOL8	10	2-9/16"(65)	2-3/4"(70)	4-1/2"(114)	1-1/4"(32)
GOL36,GOL37,GOL38,GOL	10	2-9/16"(65)	2-3/4"(70)	4-7/8"(124)	1-1/4"(32)
GOL113,GOL114	6	1"(25)	3"(76)	4-5/8"(117)	1-13/16"(46)
GOLRST	2	15/16"(24)	2-3/4"(70)	3"+6"(76)	1-1/4"(32)

NOTE: All operators are for installation into a 3/4"-14 NPSM opening except GO50 which is for 1-1/4"-11-12 NPSM and GO-11388-078 + GO-11372-093 which are for use in a 3/4"-14 NPT opening.

Push Buttons

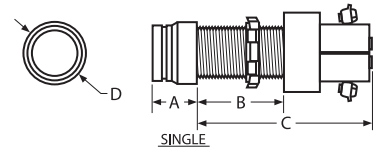

FIGURE 1

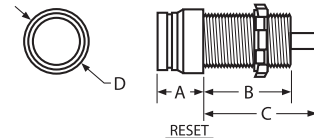

FIGURE 2

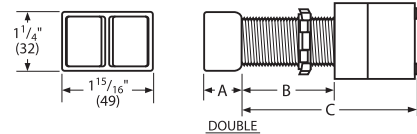

FIGURE 3

Pilot Lights

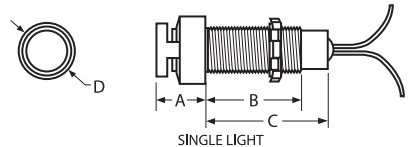

FIGURE 4

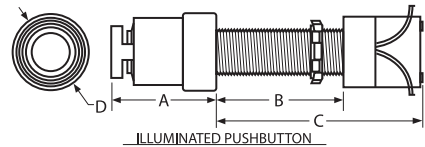

FIGURE 5

Special Operators

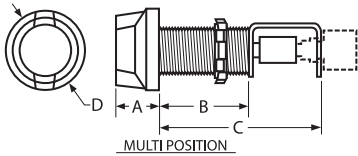

FIGURE 6

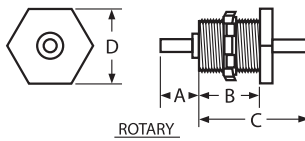

FIGURE 7

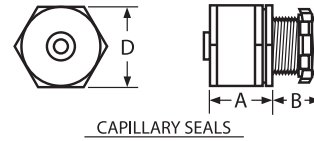

FIGURE 8

Selector Switches

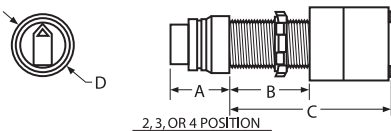

FIGURE 9

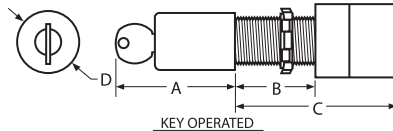

FIGURE 10

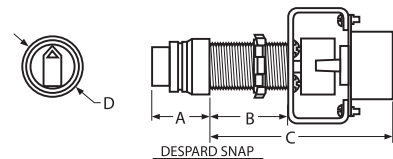

FIGURE 11